

# PRESSURE BOOSTER PUMP REPAIR PARTS

(For Pricing Refer To Repair Parts Price List)

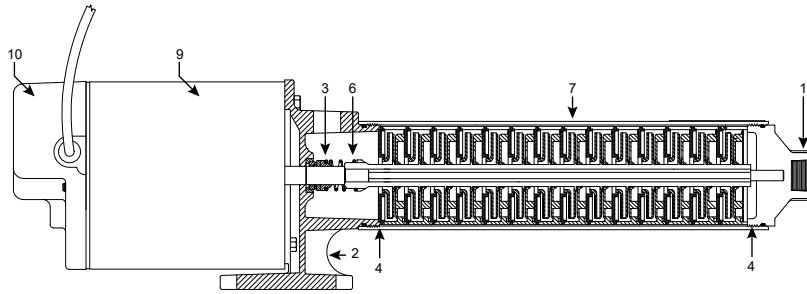

	ITEM	DESCRIPTION	QTY	CAST IRON	POWDER COATED	STAINLESS STEEL	
<b>5 - 7 - 10 - 19 GPM, 60 HZ &amp; 50 HZ</b>	1	Discharge Head 3/4" NPT	1	132000	136905	136640	See replacement motors. ITEMS 9 & 10
	2	Mounting Ring 3/4" NPT	1	132002	136904	136639	
<b>27 - 35 GPM, 60 HZ &amp; 50 HZ</b>	1	Discharge Head 1" NPT	1	136635	137796	139166	
	2	Mounting Ring 1" NPT	1	136634	137794	139100	
<b>55 - 85 GPM, 60 HZ &amp; 50 HZ</b>	1	Discharge Head 2" NPT	1	021585	-	-	
	2	Mounting Ring 2" NPT	1	021584	-	-	
<b>ALL SERIES 60 HZ &amp; 50 HZ</b>	3	Seal, Rotary w/Spring	1	131100 †	131100 †	136682 ‡	
	4	O-Ring	2	131925 ■	131925 ■	136607 ▲	
	*	Hex Head Cap Screws 3/8" x 3/4"	4	121106	121106	121106	

(†) Buna N - Carbon/Silicon Carbide (‡) Viton - Carbon/Silicon Carbide (■) Buna N (▲) Viton (\*) Not Shown

<b>60 HZ MODELS</b>	<b>MATERIAL</b>	<b>CAST IRON</b>	<b>PB0508AXXX</b>	<b>PB0512AXXX</b>	<b>PB0516AXXX</b>	<b>PB0712AXXX</b>	<b>PB1014AXXX</b>	<b>PB1016AXXX</b>
		<b>POWDER COATED</b>	<b>PB0508CXXX</b>	<b>PB0512CXXX</b>	<b>PB0516CXXX</b>	<b>PB0712CXXX</b>	<b>PB1014CXXX</b>	<b>PB1016CXXX</b>
		<b>STAINLESS STEEL</b>	<b>PB0508SXXX</b>	<b>PB0512SXXX</b>	<b>PB0516SXXX</b>	<b>PB0712SXXX</b>	<b>PB1014SXXX</b>	<b>PB1016SXXX</b>
	<b>ITEM</b>	<b>DESCRIPTION</b>	<b>PART NUMBER</b>					
	5	Cartridge Assembly ‡	135163	132939	138447	134097	134998	135814
	6	Shaft & Coupling Assembly	135161	133336	138446	133336	134996	135813
	7	Barrel/Shell	135162	132003	138448	132003	134997	135815
	<b>MATERIAL</b>	<b>CAST IRON</b>	<b>PB1914AXXX</b>	<b>PB2711AXXX</b>	<b>PB2714AXXX</b>		<b>PB3506AXXX</b>	<b>PB3508AXXX</b>
		<b>POWDER COATED</b>	<b>PB1914CXXX</b>	<b>PB2711CXXX</b>	<b>PB2714CXXX</b>		<b>PB3506CXXX</b>	<b>PB3508CXXX</b>
		<b>STAINLESS STEEL</b>	<b>PB1914SXXX</b>	<b>PB2711SXXX</b>	<b>PB2714SXXX</b>	<b>PB2717SXXX</b>	<b>PB3506SXXX</b>	<b>PB3508SXXX</b>
<b>ITEM</b>	<b>DESCRIPTION</b>	<b>PART NUMBER</b>						
5	Cartridge Assembly ‡	137222	135627	136629	020980	136626	136632	
6	Shaft & Coupling Assembly	137221	136624	136628	020916	136625	136631	
7	Barrel/Shell	137223	135628	136630	138947	136627	136633	
<b>MATERIAL</b>	<b>CAST IRON</b>	<b>PB5504XX</b>	<b>PB5506XX</b>	<b>PB8504XX</b>	<b>PB8505XX</b>			
	<b>ITEM</b>	<b>DESCRIPTION</b>	<b>PART NUMBER</b>					
	5	Cartridge Assembly ‡	022293	022294	022295	022296		
6	Shaft & Coupling Assembly	022289	022287	022288	022287			
7	Barrel/Shell	022291	022292	138151	022290			

<b>50 HZ MODELS</b>	<b>MATERIAL</b>	<b>CAST IRON</b>	<b>PB0508XXX</b>	<b>PB0514XXX</b>	<b>PB0714XXX</b>	<b>PB1020XXX</b>	<b>PB1022XXX</b>	<b>PB1023XXX</b>
		<b>POWDER COATED</b>	<b>PB0508ZXXX</b>	<b>PB0514ZXXX</b>	<b>PB0714ZXXX</b>	<b>PB1020ZXXX</b>	<b>PB1022ZXXX</b>	<b>PB1023ZXXX</b>
		<b>STAINLESS STEEL</b>	<b>PB0508YXXX</b>	<b>PB0514YXXX</b>	<b>PB0714YXXX</b>	<b>PB1020YXXX</b>	<b>PB1022YXXX</b>	<b>PB1023YXXX</b>
	<b>ITEM</b>	<b>DESCRIPTION</b>	<b>PART NUMBER</b>					
	5	Cartridge Assembly ‡	135163	138150	021032	135907	020280	135911
	6	Shaft & Coupling Assembly	135161	138149	138149	135906	020278	135910
	7	Barrel	135162	138151	138151	135098	020094	135912
	<b>MATERIAL</b>	<b>CAST IRON</b>	<b>PB1920XXX</b>		<b>PB2717XXX</b>	<b>PB3508XXX</b>	<b>PB3514XXX</b>	<b>PB3514XXX</b>
		<b>POWDER COATED</b>	<b>PB1920ZXXX</b>	<b>PB1922ZXXX</b>	<b>PB2717ZXXX</b>	<b>PB3508ZXXX</b>	<b>PB3514ZXXX</b>	<b>PB3514ZXXX</b>
		<b>STAINLESS STEEL</b>	<b>PB1920YXXX</b>		<b>PB2717YXXX</b>	<b>PB3508YXXX</b>	<b>PB3514YXXX</b>	<b>PB3514YXXX</b>
<b>ITEM</b>	<b>DESCRIPTION</b>	<b>PART NUMBER</b>						
5	Cartridge Assembly ‡	020982	139435	020980	136632	021017		
6	Shaft & Coupling Assembly	020093	021425	020916	136631	021015		
7	Barrel	020094	139436	138947	136633	021016		

(‡) Cartridge assembly includes: impellers, diffusers, o-rings and shaft & coupling assembly. Components not available individually. Sold as assembly only.