

IL1853

Screen Kit for VS Drives

CONTENTS:

Qty	P/N	Description
1	024515	Fan Filter
2	024530	Cut Screens
2	024529	Screen Retainers
8	024531	Plastic Rivets

INSTALLATION INSTRUCTIONS

1. Before opening the drive enclosure, ensure power to the drive has been turned off.
2. Pull off fan filter bracket from the bottom of the drive.

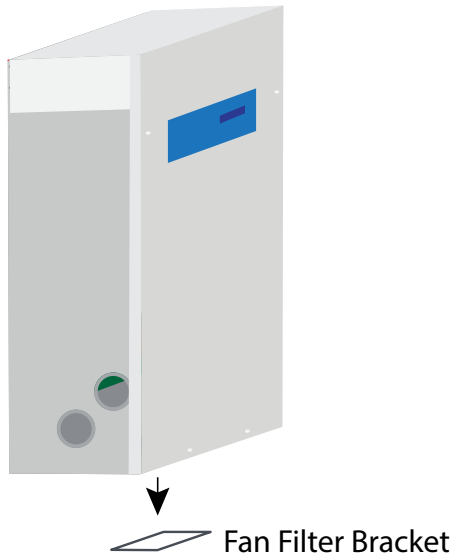

3. Place fan filter into filter bracket and snap the bracket back onto the bottom of the fan.

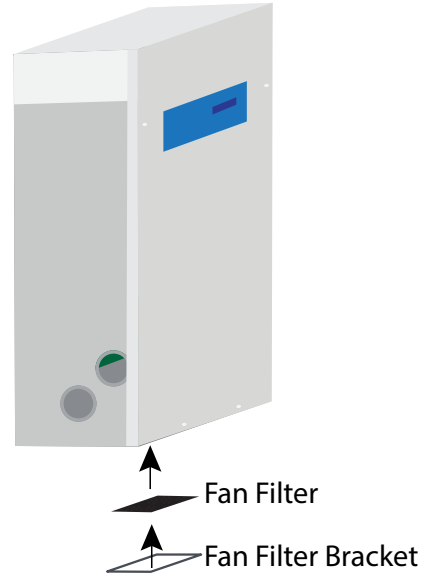

4. Remove the drive cover.

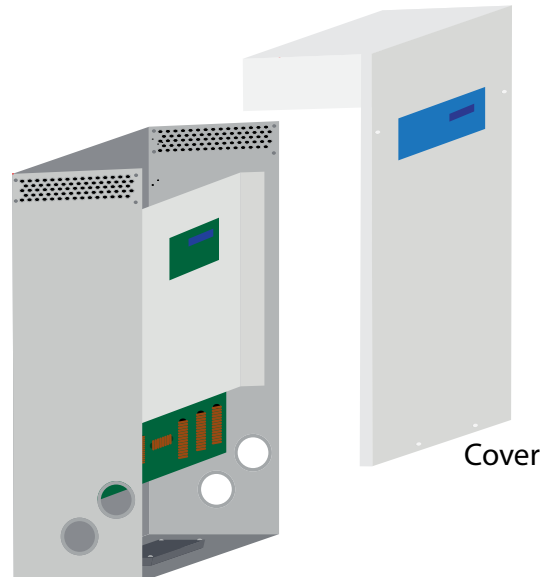

5. Line up the four holes of the cut screen piece with the inside mounting holes near the top inside vent holes of the drive. **NOTE:** angled edge of the screen goes on the top side of the drive.

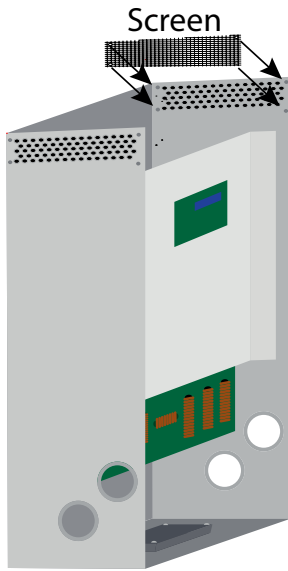

6. Line up the holes of one of the screen retainers with the mounting holes in the screen and the drive enclosure. Push the plastic rivets into the screen retainer holes.

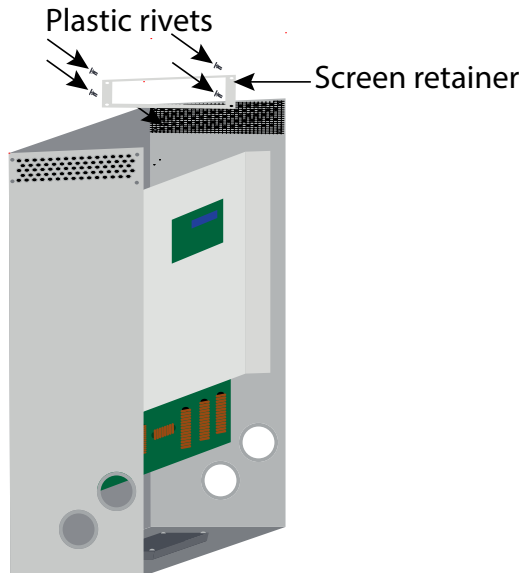

7. Repeat steps 5 and 6 for the second side of the drive.
8. Replace the drive cover and secure with screws.
9. Power up the drive.

ATTENTION: To extend the life of the drive with the screen kit installed, the fan filter and screen mesh should be cleaned on a regular basis.